

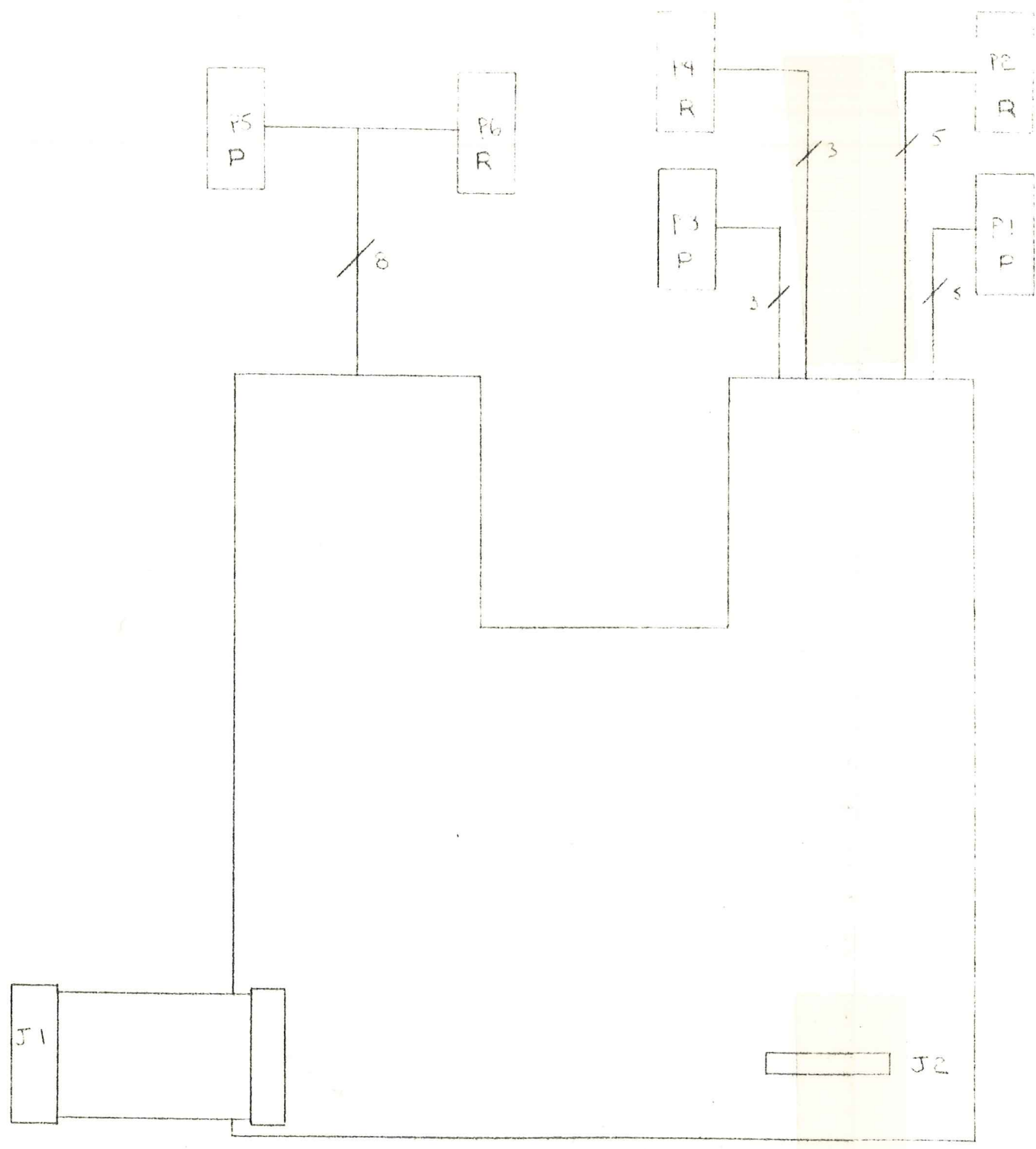

D
C
B
A



REVISIONS				
LTR	ZONE	DESCRIPTION	DATE	APPROVAL

R RECEPTICAL
P PLUG

*PCC Retrographics X10
1K PROMS*

UNLESS SPECIFIED: RESISTANCE IN OHMS CAPACITANCE IN UF DIMENSIONS IN INCHES TOLERANCE ±	 DIGITAL ENGINEERING INCORPORATED <small>SACRAMENTO, CA 95815</small>	
	INTERCONNECT DIAGRAM	
NOTICE OF CONFIDENTIAL INFORMATION INFORMATION CONTAINED HEREIN IS CONFIDENTIAL AND IS THE PROPERTY OF DIGITAL ENGINEERING. WHERE FURNISHED TO A CUSTOMER IT SHALL BE USED SOLELY FOR THE PURPOSES OF INSPECTION, INSTALLATION OR MAINTENANCE. THE INFORMATION SHALL NOT BE USED OR DISCLOSED BY THE RECIPIENT FOR ANY OTHER PURPOSE WHATSOEVER.	APPROVALS	DATE
	DRAWN	
	CHECKED	
	APPROVED <i>T.J.C.</i>	26 SEP 79
ENGINEERED		
	SIZE C	DOCUMENT NUMBER RG512-00001
		REV. 1.3
		SHEET 1 OF 1

D
C
B
A

LTR	ZONE	DESCRIPTION	DATE	APPROVAL

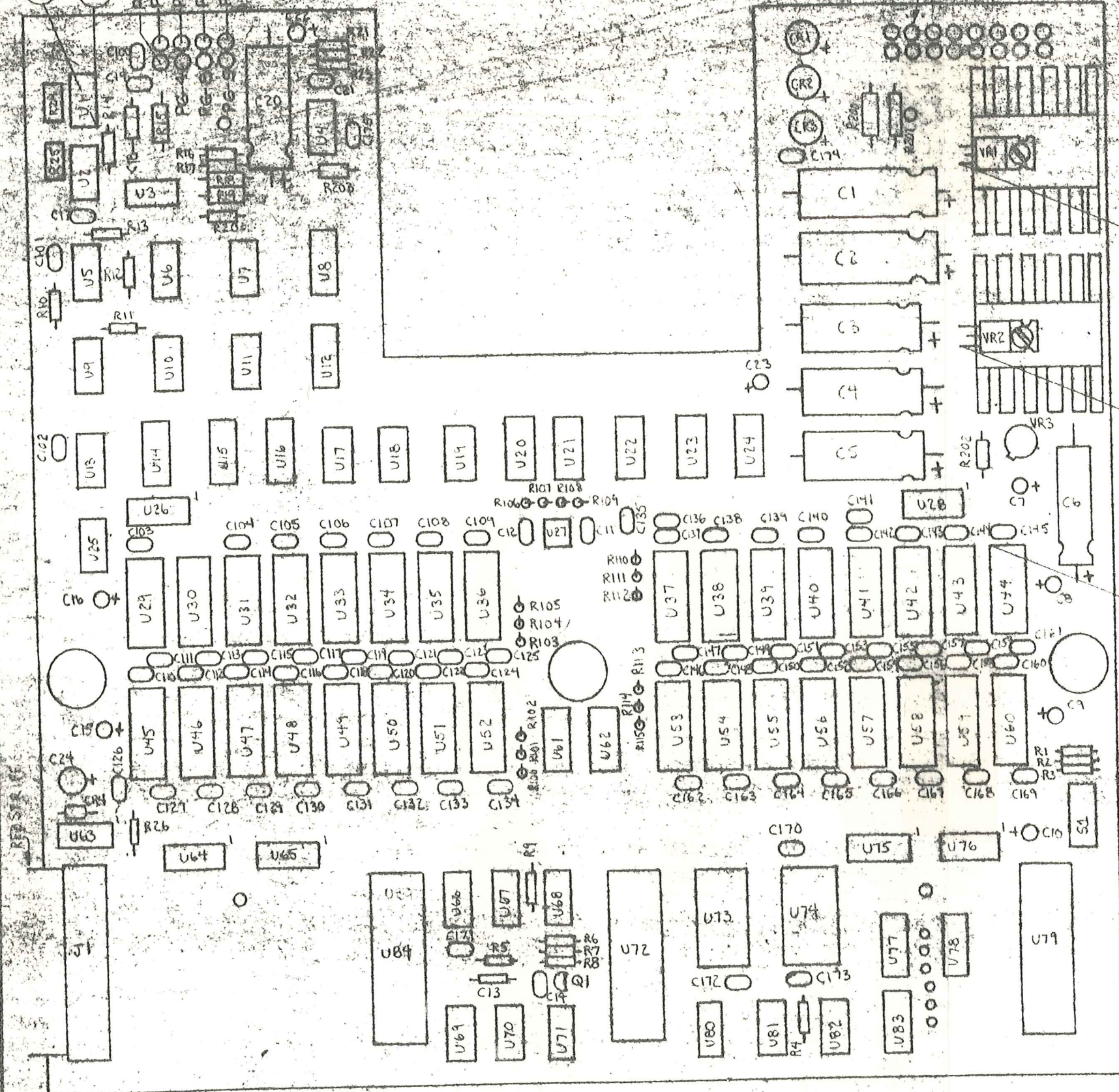

TP2

TP1

TP3

U44-1

P1-1	P2-100
P1-2	P2-200
P1-3	P2-300
P1-4	P2-400
P1-5	P2-500
P3-1	P4-100
P3-2	P4-200
P3-3	P4-300

DETAIL A

UNLESS SPECIFIED:
 RESISTANCE IN OHMS
 CAPACITANCE IN UF
 DIMENSIONS IN INCHES
 TOLERANCE ±

DIGITAL ENGINEERING
 INCORPORATED
 SACRAMENTO, CA 95815

NOTICE OF CONFIDENTIAL INFORMATION
 INFORMATION CONTAINED HEREIN IS CONFIDENTIAL AND IS THE PROPERTY OF DIGITAL ENGINEERING. WHERE FURNISHED TO A CUSTOMER IT SHALL BE USED SOLELY FOR THE PURPOSES OF INSPECTION, INSTALLATION OR MAINTENANCE. THE INFORMATION SHALL NOT BE USED OR DISCLOSED BY THE RECIPIENT FOR ANY OTHER PURPOSE WHATSOEVER.

APPROVALS	DATE
DRAWN	
CHECKED	
APPROVED <i>J/L</i>	2/5/79
ENGINEERED	

CIRCUIT LOCATION DIAGRAM	
SIZE C	DOCUMENT NUMBER R6512-00004
	REV. B

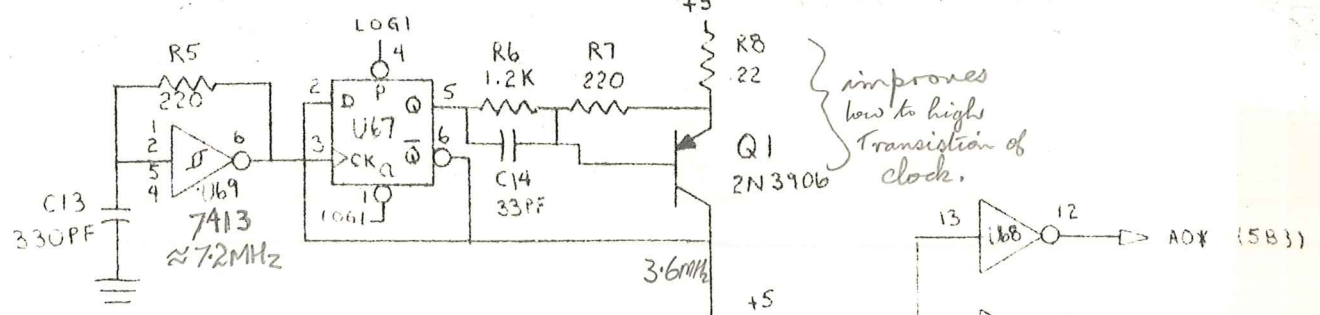

REVISIONS				
LTR	ZONE	DESCRIPTION	DATE	APPROVAL

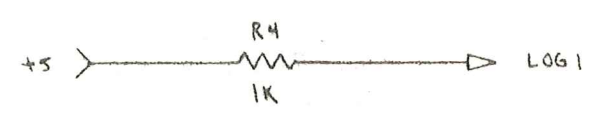
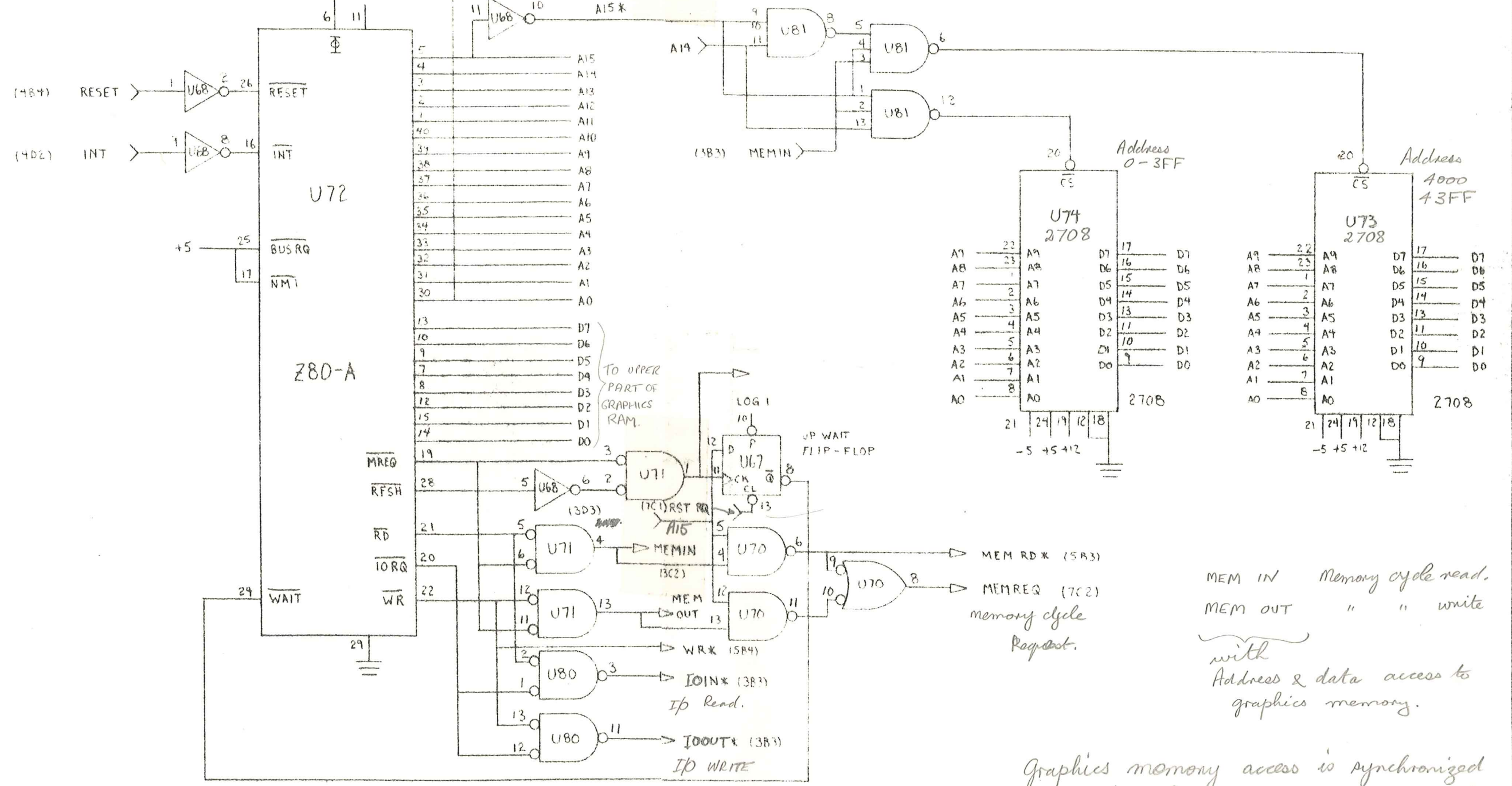

UNLESS SPECIFIED: RESISTANCE IN OHMS CAPACITANCE IN UF DIMENSIONS IN INCHES TOLERANCE \pm	 SACRAMENTO, CA 95815		LOGIC DIAGRAM		
			APPROVALS	DATE	SIZE
NOTICE OF CONFIDENTIAL INFORMATION INFORMATION CONTAINED HEREIN IS CONFIDENTIAL AND IS THE PROPERTY OF DIGITAL ENGINEERING. WHERE FURNISHED TO A CUSTOMER IT SHALL BE USED SOLELY FOR THE PURPOSES OF INSPECTION, INSTALLATION OR MAINTENANCE. THE INFORMATION SHALL NOT BE USED OR DISCLOSED BY THE RECIPIENT FOR ANY OTHER PURPOSE WHATSOEVER.	DRAWN		C	RG512-00005	
	CHECKED				REV. 1.3
	APPROVED	26SEP79			SHEET 3 OF 9
ENGINEERED					

LTR	ZONE	DESCRIPTION	DATE	APPROVAL

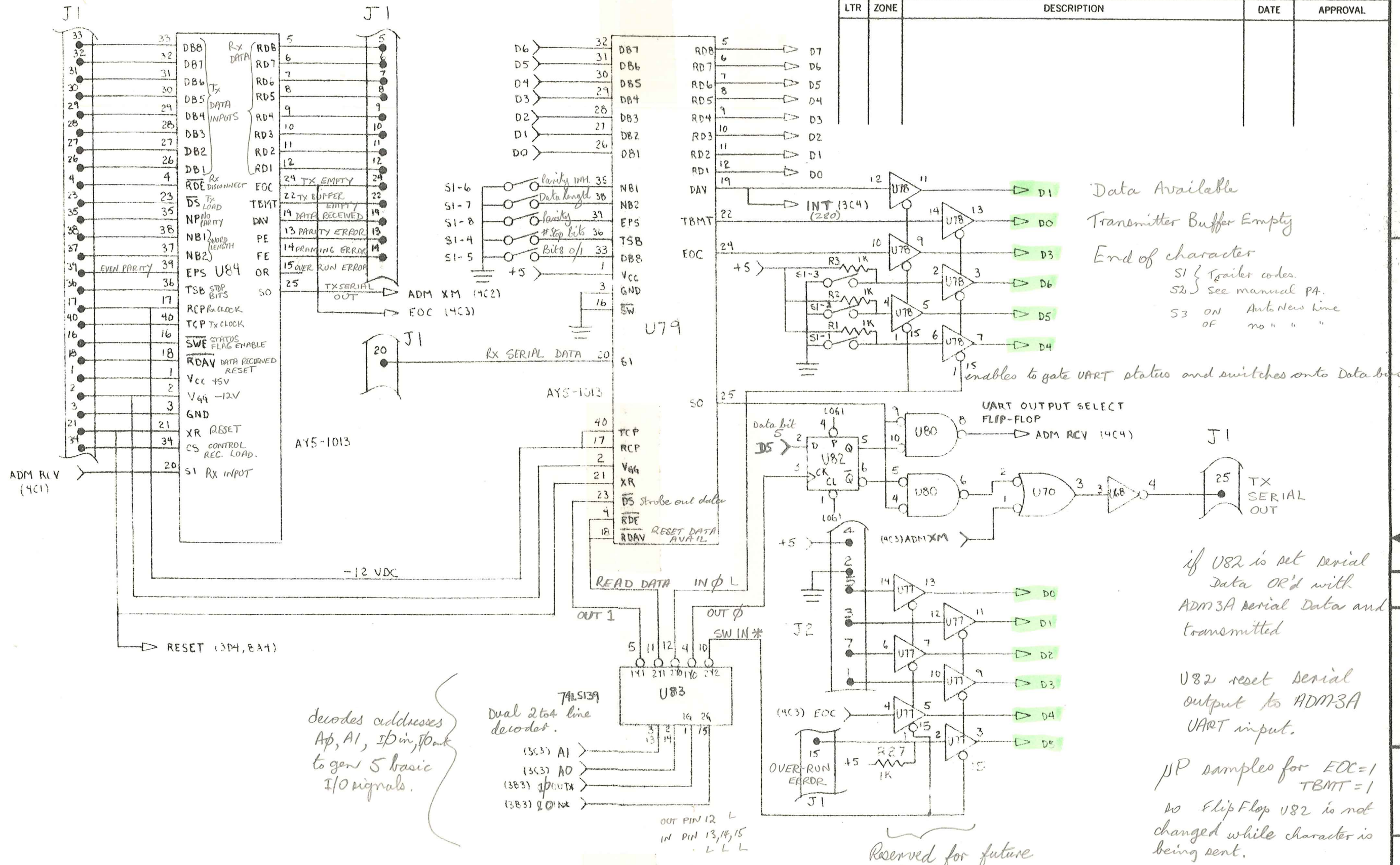

Data Available
Transmitter Buffer Empty
End of character
S1 { Trailer codes
S2 } See manual PA.
S3 ON Auto New line
OF " " "

enables to gate UART status and switches onto Data bus

if U82 is set Serial Data OR'd with ADM-3A serial Data and transmitted

U82 reset Serial output to ADM-3A UART input.

µP samples for EOC=1 TBMT=1
no FlipFlop U82 is not changed while character is being sent.

Reserved for future expansion.

decodes addresses Ap, A1, IPin, IPout to gen 5 basic I/O signals.

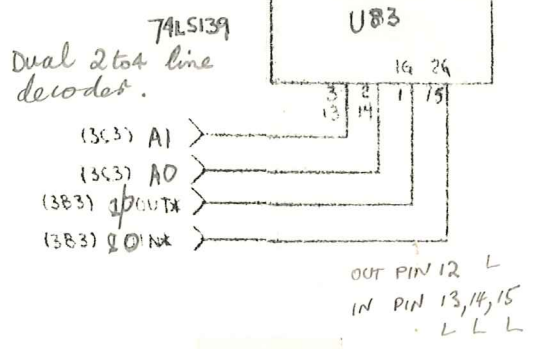

UNLESS SPECIFIED: RESISTANCE IN OHMS CAPACITANCE IN UF DIMENSIONS IN INCHES TOLERANCE ±		DIGITAL ENGINEERING INCORPORATED SACRAMENTO, CA 95815	
NOTICE OF CONFIDENTIAL INFORMATION INFORMATION CONTAINED HEREIN IS CONFIDENTIAL AND IS THE PROPERTY OF DIGITAL ENGINEERING. WHERE FURNISHED TO A CUSTOMER IT SHALL BE USED SOLELY FOR THE PURPOSES OF INSPECTION, INSTALLATION OR MAINTENANCE. THE INFORMATION SHALL NOT BE USED OR DISCLOSED BY THE RECIPIENT FOR ANY OTHER PURPOSE WHATSOEVER.		APPROVALS	DATE
DRAWN			
CHECKED			
APPROVED <i>T.J.L.</i>		26 SEP 79	
ENGINEERED			
SIZE C		DOCUMENT NUMBER RG512-00008	
		REV. 1.3	
		SHEET 4 OF 9	

LTR	ZONE	DESCRIPTION	DATE	APPROVAL

MP Addresses Bits A2 to A13
 Video Refresh Addresses
 CC1 - CC5
 LC0 - LC7

Controls
 Address selection

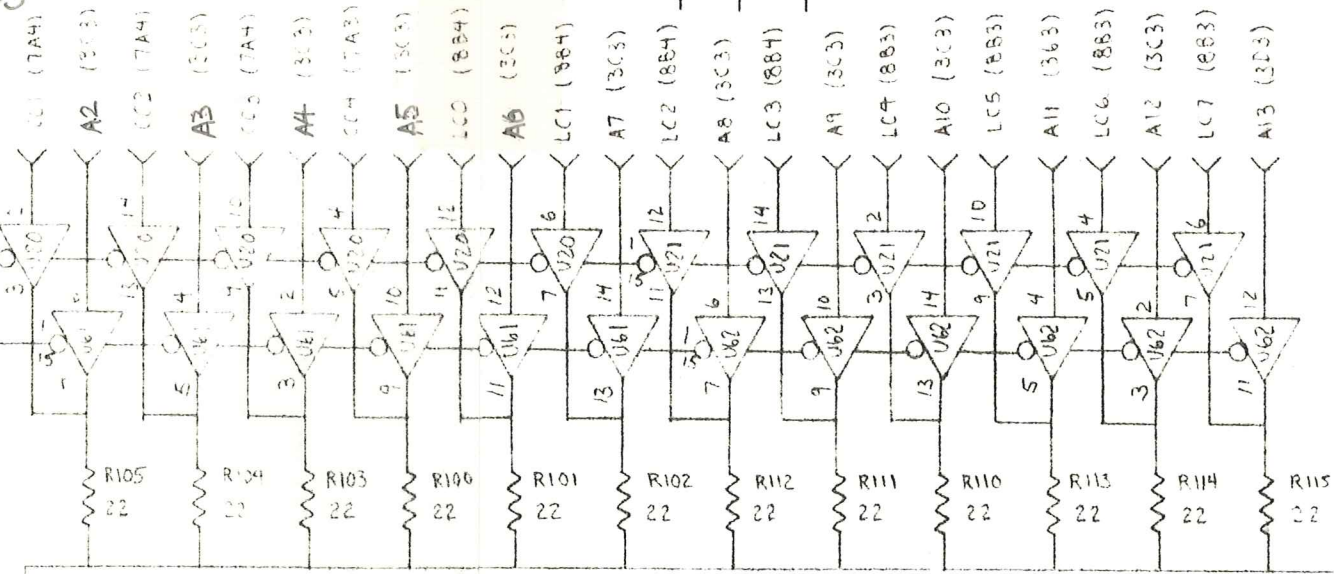

damping resistors to limit overshoot.

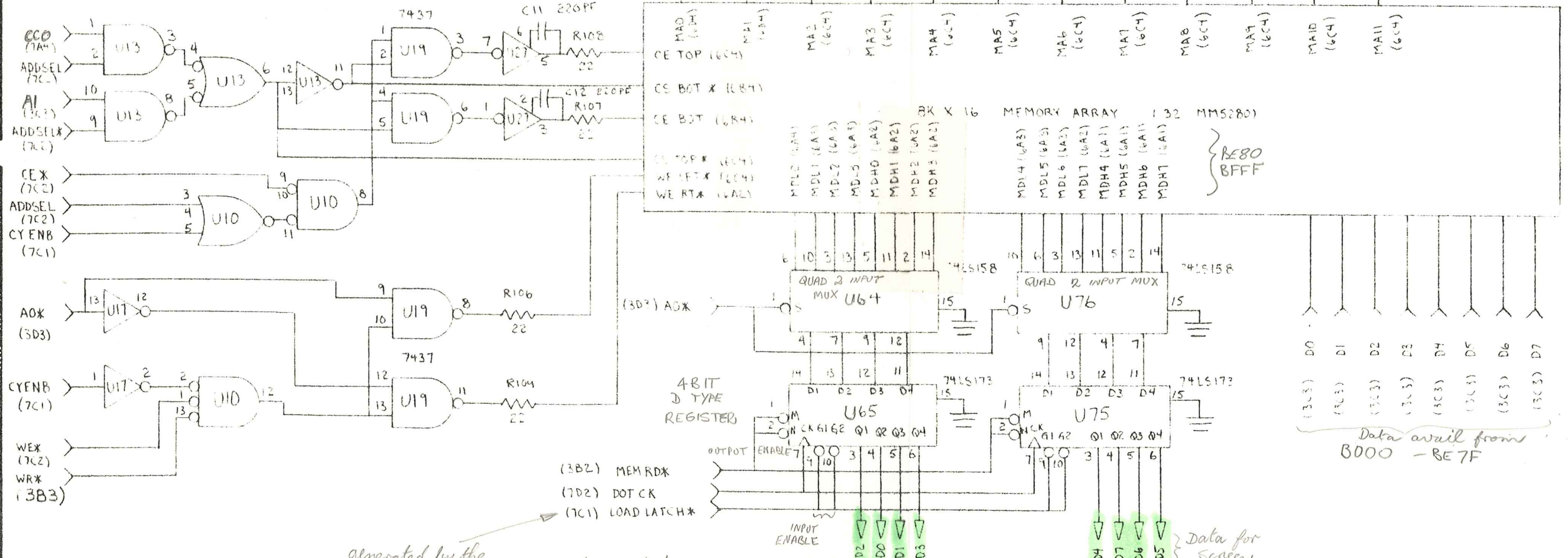

generated by the Router Timing Section

output data latched by U65 & U75 for READ cycle

UNLESS SPECIFIED:
 RESISTANCE IN OHMS
 CAPACITANCE IN UF
 DIMENSIONS IN INCHES
 TOLERANCE ±

DIGITAL ENGINEERING
 INCORPORATED
 SACRAMENTO, CA 95815

NOTICE OF CONFIDENTIAL INFORMATION
 INFORMATION CONTAINED HEREIN IS CONFIDENTIAL AND IS THE PROPERTY OF DIGITAL ENGINEERING. WHERE FURNISHED TO A CUSTOMER IT SHALL BE USED SOLELY FOR THE PURPOSES OF INSPECTION, INSTALLATION OR MAINTENANCE. THE INFORMATION SHALL NOT BE USED OR DISCLOSED BY THE RECIPIENT FOR ANY OTHER PURPOSE WHATSOEVER.

APPROVALS	DATE
DRAWN	
CHECKED	
APPROVED <i>T.A.C.</i>	26 SEP 77
ENGINEERED	

LOGIC DIAGRAM	
SIZE C	DOCUMENT NUMBER RG512-00007
	REV. 1.3
SHEET 5 OF 9	

LTR	ZONE	DESCRIPTION	DATE	APPROVAL

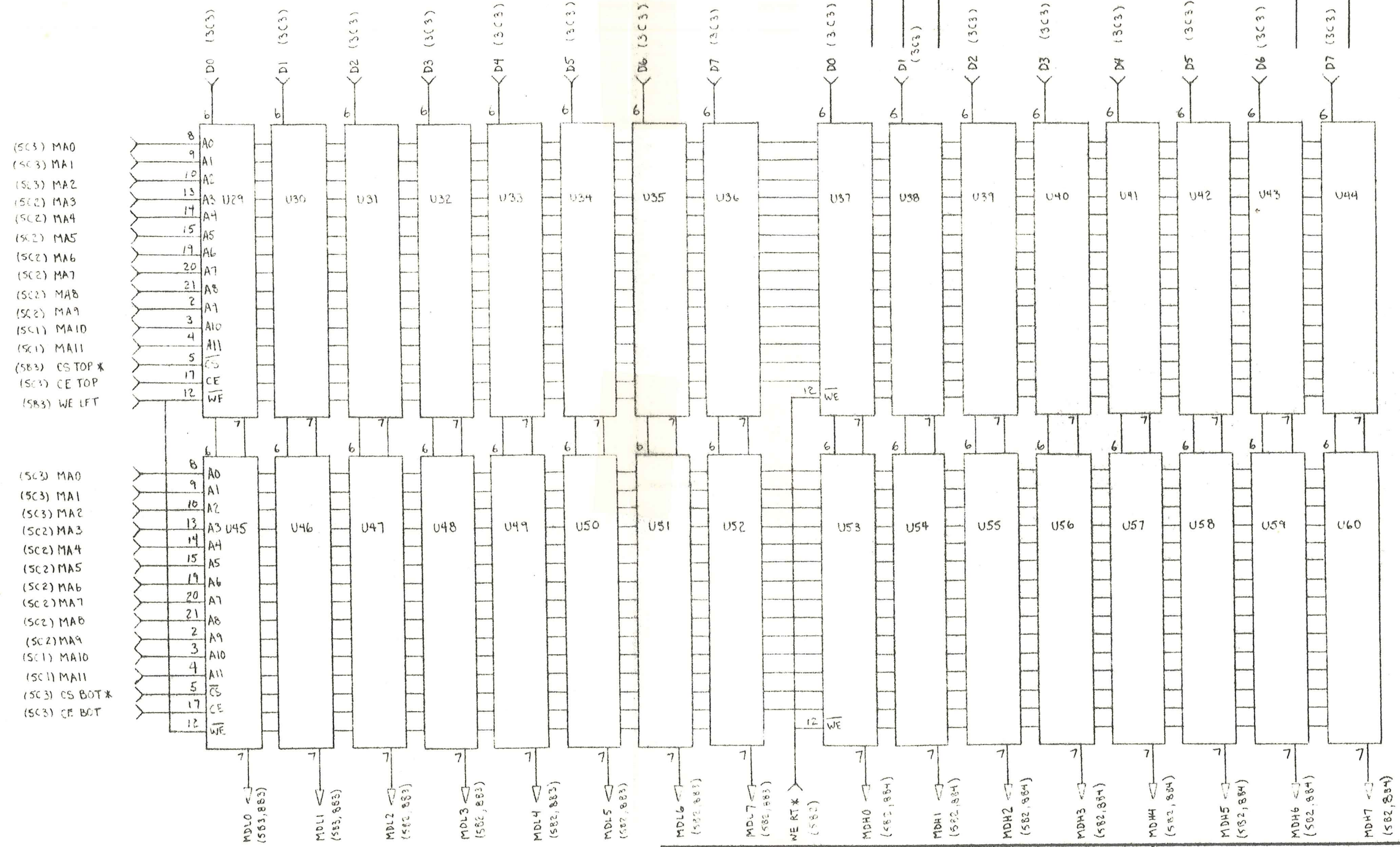

- (SC3) MA0
- (SC3) MA1
- (SC3) MA2
- (SC2) MA3
- (SC2) MA4
- (SC2) MA5
- (SC2) MA6
- (SC2) MA7
- (SC2) MA8
- (SC2) MA9
- (SC1) MA10
- (SC1) MA11
- (SB3) CS TOP *
- (SC3) CE TOP
- (SB3) WE LFT

- (SC3) MA0
- (SC3) MA1
- (SC3) MA2
- (SC2) MA3
- (SC2) MA4
- (SC2) MA5
- (SC2) MA6
- (SC2) MA7
- (SC2) MA8
- (SC2) MA9
- (SC1) MA10
- (SC1) MA11
- (SC3) CS BOT *
- (SC3) CE BOT

MM5280 (32) POWER:
 PIN 1. -5V 11. +5V 18. +12V 22. GROUND

UNLESS SPECIFIED:
 RESISTANCE IN OHMS
 CAPACITANCE IN UF
 DIMENSIONS IN INCHES
 TOLERANCE ±

DIGITAL ENGINEERING
 INCORPORATED
 SACRAMENTO, CA 95815

NOTICE OF CONFIDENTIAL INFORMATION
 INFORMATION CONTAINED HEREIN IS CONFIDENTIAL AND IS THE PROPERTY OF DIGITAL ENGINEERING. WHERE FURNISHED TO A CUSTOMER IT SHALL BE USED SOLELY FOR THE PURPOSES OF INSPECTION, INSTALLATION OR MAINTENANCE. THE INFORMATION SHALL NOT BE USED OR DISCLOSED BY THE RECIPIENT FOR ANY OTHER PURPOSE WHATSOEVER.

APPROVALS	DATE
DRAWN	
CHECKED	
APPROVED <i>T.D.C.</i>	26SEP79
ENGINEERED	

LOGIC DIAGRAM		
SIZE	DOCUMENT NUMBER	REV. 1.3
C	RG512-00008	
		SHEET 6 OF 9

LTR	ZONE	DESCRIPTION	DATE	APPROVAL

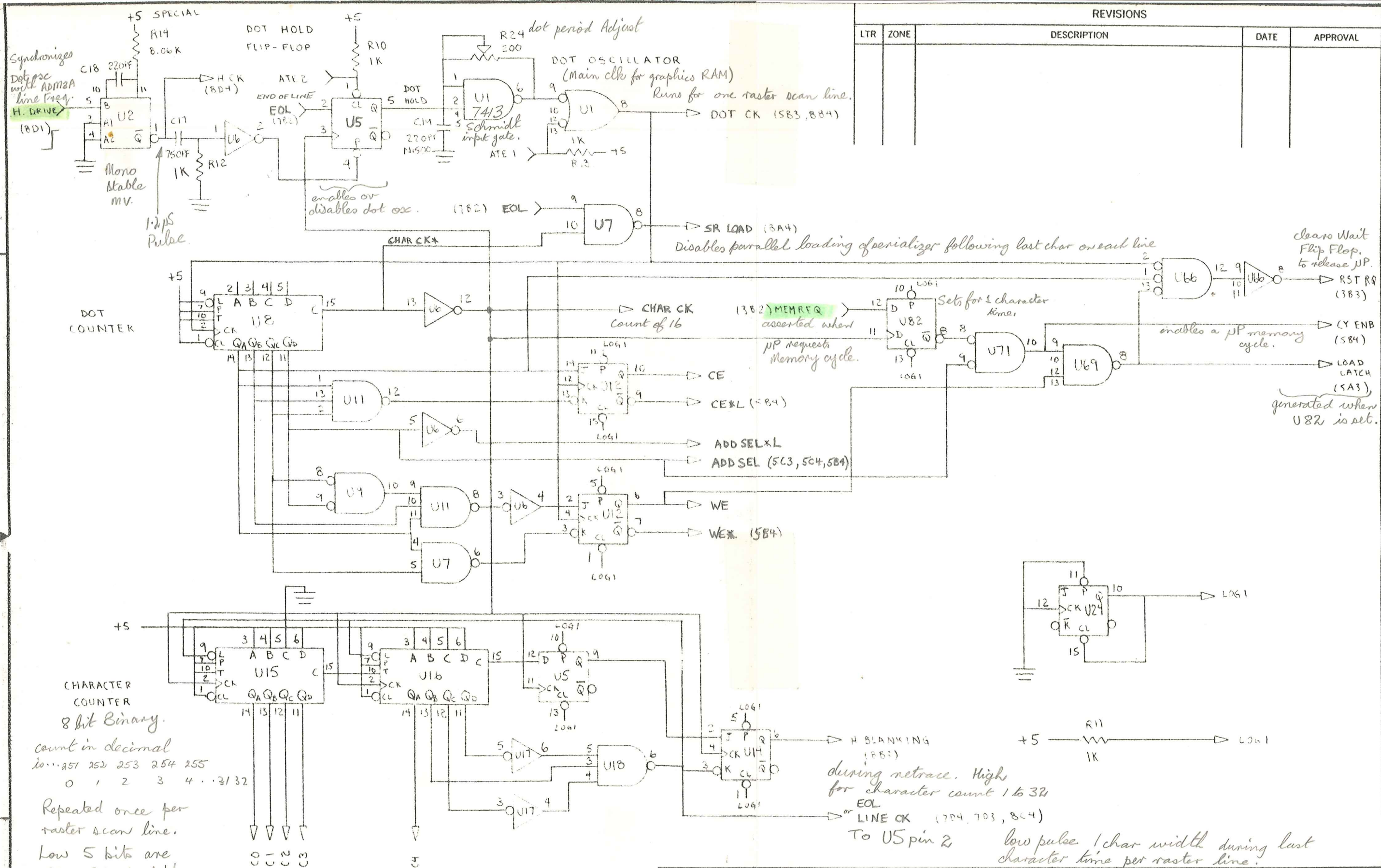

CHARACTER COUNTER
8 bit Binary.
count in decimal
00...251 252 253 254 255
0 1 2 3 4 ... 31 32
Repeated once per
raster scan line.
Low 5 bits are
Video Refresh Address
Dot oscillator stopped
following the count to 32

H BLANKING (8B3)
during retrace. High
for character count 1 to 32
EOL
or LINE CK (704, 703, 8C4)
To U5 pin 2 low pulse 1 char width during last
character time per raster line.

UNLESS SPECIFIED: RESISTANCE IN OHMS CAPACITANCE IN UF DIMENSIONS IN INCHES TOLERANCE ±	DIGITAL ENGINEERING I N C O R P O R A T E D SACRAMENTO, CA 95815	
	NOTICE OF CONFIDENTIAL INFORMATION INFORMATION CONTAINED HEREIN IS CONFIDENTIAL AND IS THE PROPERTY OF DIGITAL ENGINEERING. WHERE FURNISHED TO A CUSTOMER IT SHALL BE USED SOLELY FOR THE PURPOSES OF INSPECTION, INSTALLATION OR MAINTENANCE. THE INFORMATION SHALL NOT BE USED OR DISCLOSED BY THE RECIPIENT FOR ANY OTHER PURPOSE WHATSOEVER.	APPROVALS DRAWN CHECKED APPROVED <i>TJC</i> ENGINEERED

LTR	ZONE	DESCRIPTION	DATE	APPROVAL

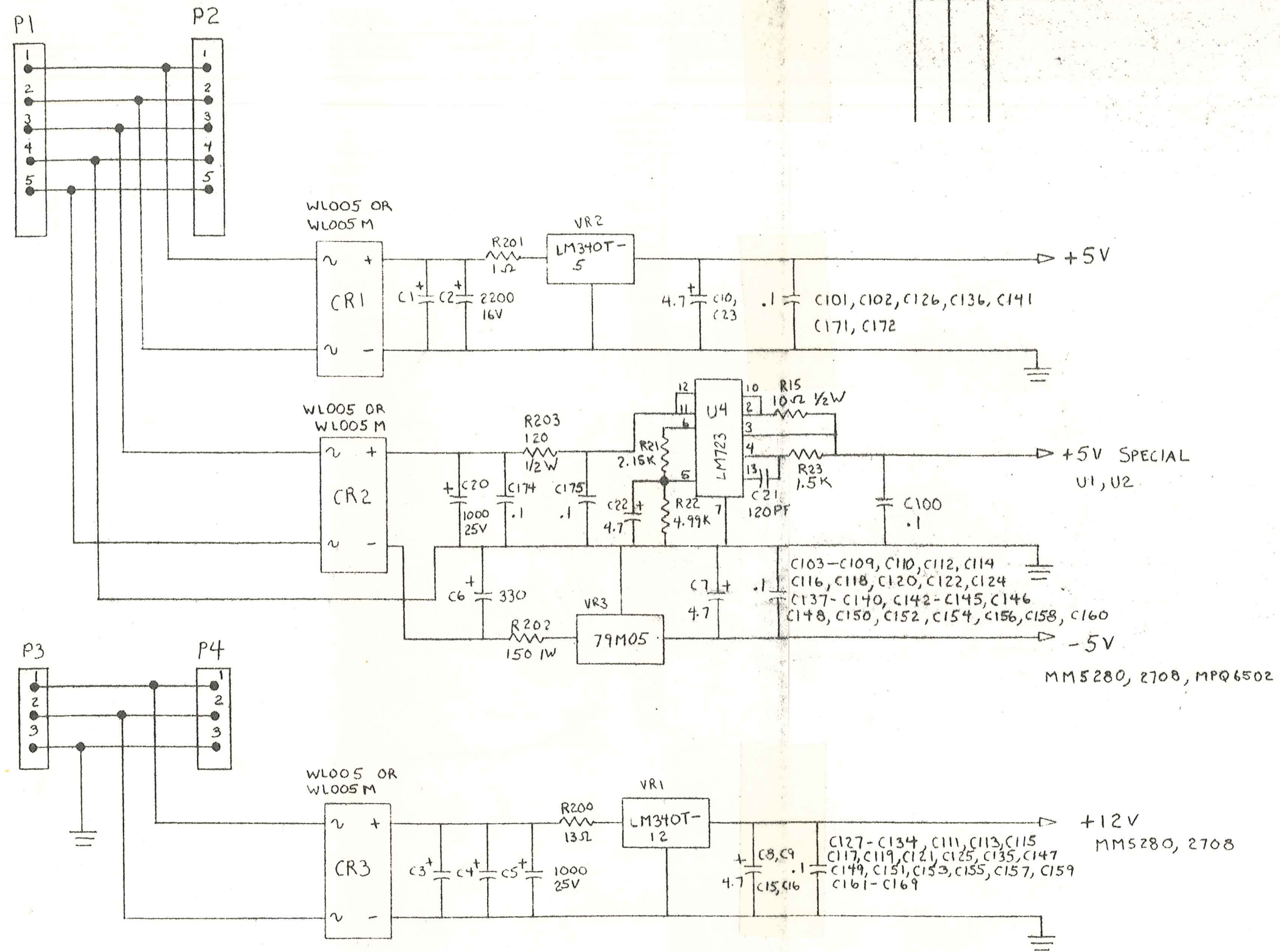

POWER SUPPLY

UNLESS SPECIFIED: RESISTANCE IN OHMS CAPACITANCE IN UF DIMENSIONS IN INCHES TOLERANCE ±	DIGITAL ENGINEERING INCORPORATED SACRAMENTO, CA 95815	
	NOTICE OF CONFIDENTIAL INFORMATION INFORMATION CONTAINED HEREIN IS CONFIDENTIAL AND IS THE PROPERTY OF DIGITAL ENGINEERING. WHERE FURNISHED TO A CUSTOMER IT SHALL BE USED SOLELY FOR THE PURPOSES OF INSPECTION, INSTALLATION OR MAINTENANCE. THE INFORMATION SHALL NOT BE USED OR DISCLOSED BY THE RECIPIENT FOR ANY OTHER PURPOSE WHATSOEVER.	APPROVALS DRAWN CHECKED APPROVED <i>T.J.C.</i> ENGINEERED

REVISIONS				
LTR	ZONE	DESCRIPTION	DATE	APPROVAL

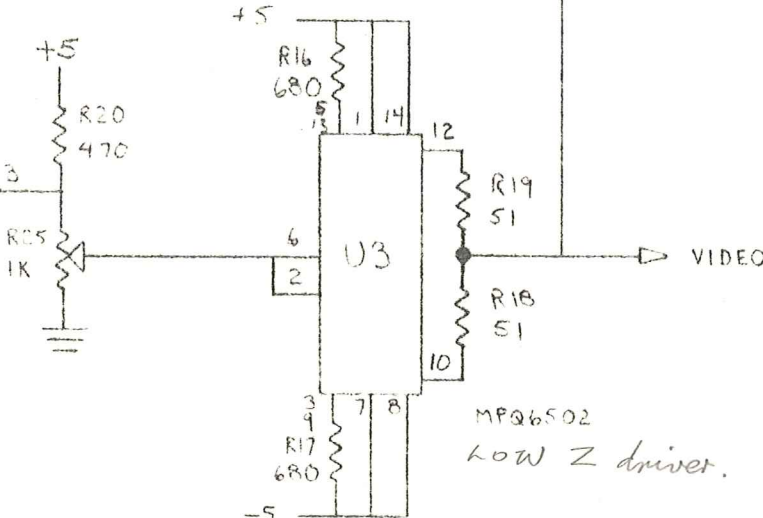
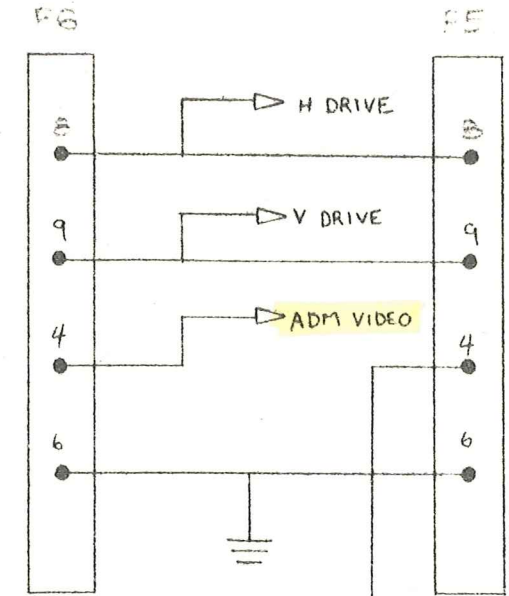
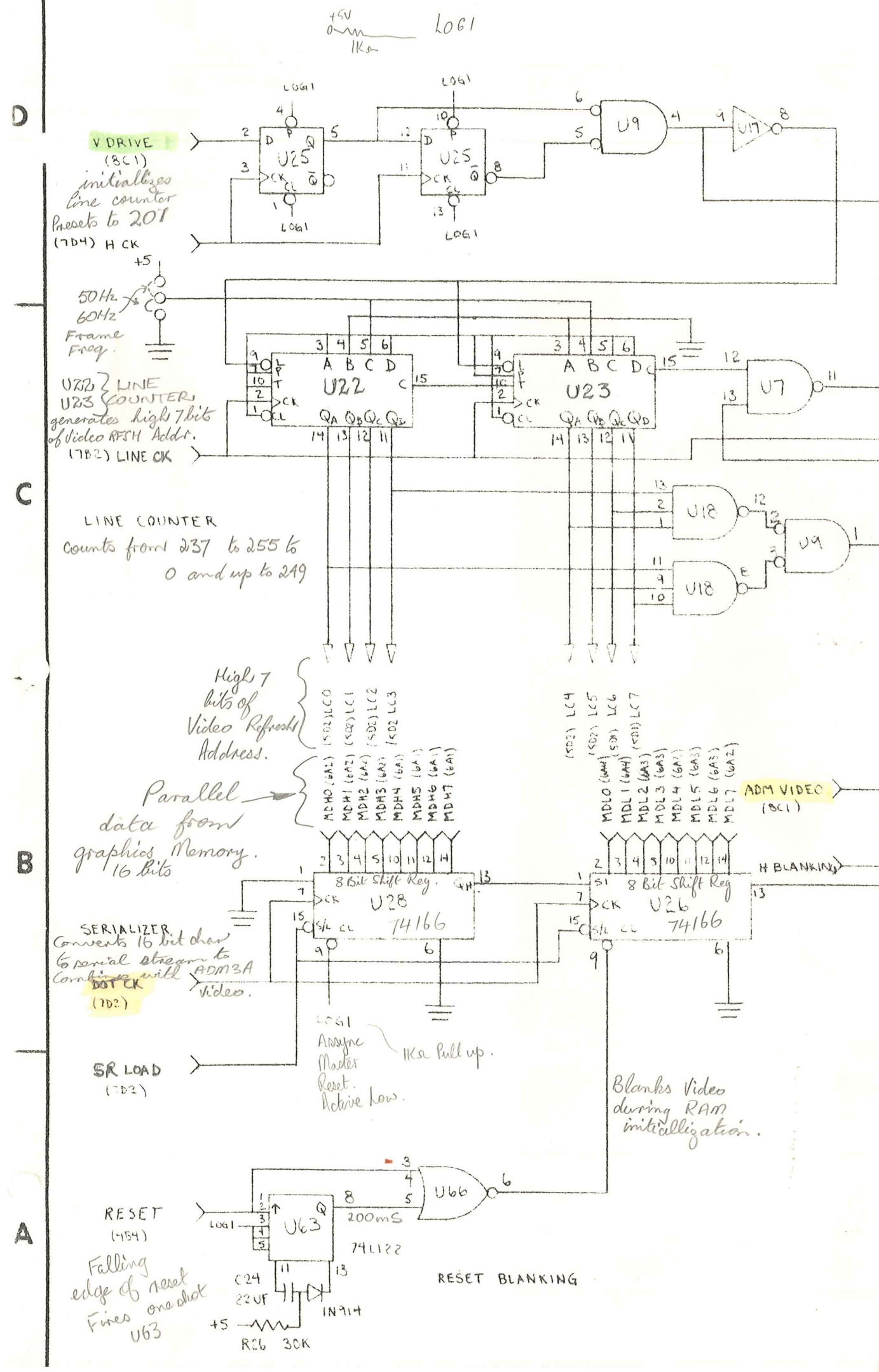

UNLESS SPECIFIED: RESISTANCE IN OHMS CAPACITANCE IN UF DIMENSIONS IN INCHES TOLERANCE \pm	DIGITAL ENGINEERING INCORPORATED SACRAMENTO, CA 95815	
	APPROVALS	DATE
NOTICE OF CONFIDENTIAL INFORMATION INFORMATION CONTAINED HEREIN IS CONFIDENTIAL AND IS THE PROPERTY OF DIGITAL ENGINEERING. WHERE FURNISHED TO A CUSTOMER IT SHALL BE USED SOLELY FOR THE PURPOSES OF INSPECTION, INSTALLATION OR MAINTENANCE. THE INFORMATION SHALL NOT BE USED OR DISCLOSED BY THE RECIPIENT FOR ANY OTHER PURPOSE WHATSOEVER.	DRAWN	
	CHECKED	
	APPROVED T.C.	26 SEP 79
	ENGINEERED	
LOGIC DIAGRAM		
SIZE C	DOCUMENT NUMBER RG512-00010	REV. 1.3
		SHEET 8 OF 9